

2nd Floor West, St Martins Place
Phase 3 - Draft Accommodation Proposal
Jamila Ibrahim
07/03/2013
SMP West 2nd Fl 070313

Existing	Teams		Storage	
	Desk Allocation	High	Low	
● Sure Start & Raising Achievement	30		30	
● Finance Team	32		18	
● External Audit	3		1	
● Environmental Services + 1 Fridge	12	5	16	
● PH review	6		2	
● Auvtar Lakhan CWB Team	6		5	
● Business Support	7	4	3	
● Food Safety + Fridge	10		9	
● Trading Standards + Fridge	8		7	
● DAAT	6		11	
● Community Safety + 3 Project Officers	8			
● Neighbourhood Enforcement	6		4	
● Business Transformational Officers	3	3	2	
● Performance & Learning & Development	12	3	2	
● Community & Wellbeing Transport	4		5	
● Hot Desks	12			
● Reviewing	8			
● Emergency Planning	1			
● Pods	2			
● Health & Safety	3		3	
Assistant Director, Finance Office	1		1	
Assistant Director Housing & Environment Office	1			
PA to Pat Kellerher	1		1	
Spare	5	5	1	
Total	187	20	121	

Proposed layout

- 1600 wave desks: 2 desks. No change
 - 1200 desks: 187 existing plus 7 extra
 - Tall Storage: 52 actual. 20 existing cupboards plus 32 extra (which is equal to 64 Low cupboards)
 - Low Storage: 46 actual. 121 existing. 75 less cupboards, (an actual loss of 9 Low cupboards overall)
 - Meeting rooms: 1 existing plus 8 extra
 - Informal meeting areas: 1 plus 5 extra
- New desks and rooms shown as drawn in green

Date : 07/03/2013
Drawing: SMP West 2nd Fl 070313
Drawn : JW

Site Location:
Slough Borough Council
St Martins Place,
Bath Road,
Slough

All dimensions shown are approximate and must be checked on site prior to building

Copyright
This drawing remains the property of
Slough Borough Council



working with



Styles House Wood Street
Waddesdon HP18 0NN
Design office 01296 658463
Administration 01296 655329

EXISTING

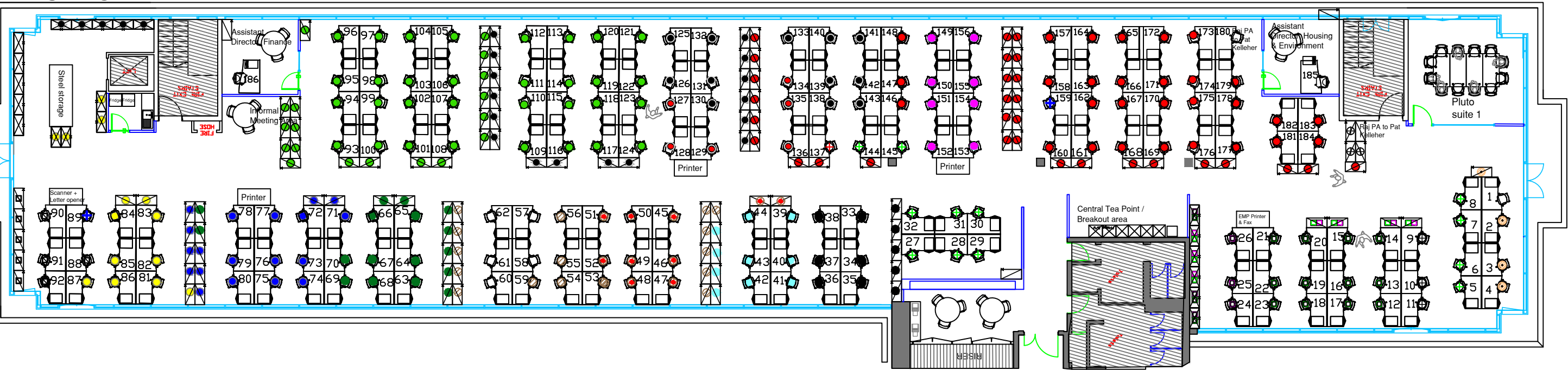

PROPOSED

